

**UCPA**  
Cylindrical bore (with set screws)  
d 12 ~ 50 mm

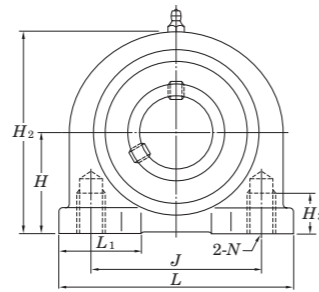
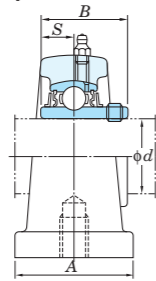

Variations of tolerance of distance from mounting bottom to center of spherical bore ( $\Delta H_s$ ) and variations of tolerance of distance between centers of bolt holes ( $\Delta L_s$ )

Housing No.	$\Delta H_s$	$\Delta L_s$
PA204-PA210	±0.15	±0.5

Unit: mm

Shaft Dia. mm inch	Dimensions inch mm	Unit No.	Housing No.	Bearing No.	Basic Load Ratings kN		Factor $f_0$	Mass kg
					$C_r$	$C_{0r}$		
$d$	$H$ $L$ $A$ $J$ $N$ $H_2$ $H_3$ $L_1$ $B$ $S$							
12 1/2		UCPA201 UCPA201-8 UCPA202 UCPA202-10 UCPA203 UCPA204-12 UCPA204	PA204	UC201 UC201-8 UC202 UC202-10 UC203 UC204-12 UC204	12.8	6.65	13.2	0.64 0.62 0.61 0.59
15 5/8	1 3/16 3 1 9/16 2 3/64	M10×1.5						
17 3/4	30.2 76 40 52	60 13 27 31 12.7						
20								
25 7/8 15/16	1 7/16 3 5/16 1 25/32 2 13/64	M10×1.5	PA205	UC205-14 UC205-15 UC205 UC205-16	14.0	7.85	13.9	0.83
25 1	36.5 84 45 56	71 13 30 34.1 14.3						
30 1 1/8 1 3/16 1 1/4	1 11/16 3 11/16 1 31/32 2 19/32	M14×2	PA206	UC206-18 UC206 UC206-19 UC206-20	19.5	11.3	13.9	1.2
30 1 1/4	42.9 94 50 66	84 18 36 38.1 15.9						
35 1 5/16 1 3/8 1 7/16	1 7/8 3 11/32 2 5/32 3 5/32	M14×2	PA207	UC207-20 UC207-21 UC207-22 UC207 UC207-23	25.7	15.4	13.9	1.7
35 1 7/16	47.6 110 55 80	93 20 41 42.9 17.5						
40 1 1/2 1 9/16	1 15/16 4 9/16 2 9/32 3 5/16	M14×2	PA208	UC208-24 UC208-25 UC208	29.1	17.8	14.0	2.0
40 1 1/2	49.2 116 58 84	100 20 41 49.2 19						
45 1 5/8 1 11/16 1 3/4	2 9/64 4 23/32 2 3/8 3 35/64	M14×2	PA209	UC209-26 UC209-27 UC209-28 UC209	34.1	21.3	14.0	2.2
45 1 3/4	54.2 120 60 90	106 25 42 49.2 19						
50 1 7/8 1 15/16 2	2 1/4 5 1/8 2 17/32 3 45/64	M16×2	PA210	UC210-30 UC210-31 UC210 UC210-32	35.1	23.3	14.4	2.8
50 2	57.2 130 64 94	113 25 47 51.6 19						

Remarks 1. In Part No. of unit, fitting codes follow bore diameter codes. (See Table 10.5 in P.51.)

2. Part No. of the applicable grease fitting is A-1/4-28UNF.

3. As for the triple seal type product (from 201 to 205 are the double seal type products), accessory code L3 (or L2) follows Part No. of unit or bearing. (Example of Part No. : UCPA206JL3, UC206L3)

4. As for the dimensions and forms of applicable bearings, see the dimensional tables of ball bearing for unit.

5. Tapered bore (with adapter) type products are also available. (Example of Part No. : UKPA205J + H305X, UK205 + H305X)

6. Housings of nodular graphite cast iron are also available.